

# Glass installation

We have developed the Van Ruysdael mastic to make the glass and existing frames of windows stand out even longer and more beautifully. A glazing material that extends the shelf life of glass, windows and paintwork. It reduces costs and is good for the environment.

Do not use sharp or coarse equipment that are harder than glass, such as sharp knives, sandpaper or sand. If the rebate is damaged during removal, repair these damages before the glass is installed. When cleaning within 48 hours of installation: never add more than 3% PH neutral soap to the water. More soap dissolves the sealant. This could spread on the glass and is then difficult or impossible to remove. When using spacer blocks: fit wooden or plastic (certainly not neoprene) fitting wedges if necessary.

Van Ruysdael's mastic can be ordered via the website or by sending an e-mail to [mail@van-ruysdael.com](mailto:mail@van-ruysdael.com).



Van Ruysdael advises installation of Van Ruysdael® glass according to the guidelines below. This example is based on 6,5mm Van Ruysdael® glass. Adhesive labels are generally on the outside of the glass.

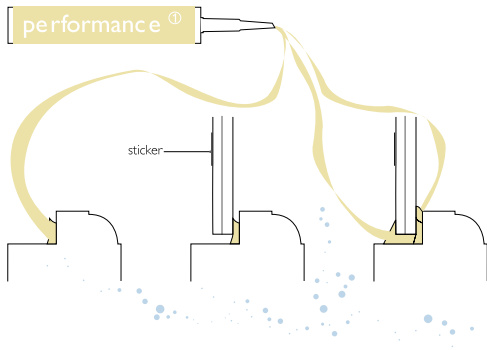

Van Ruysdael's mastic has 2 components:

Van Ruysdael Performance is a glass bonding and sealing mastic.

Van Ruysdael Detail is a smooth finishing mastic.

Van Ruysdael Assist is a liquid that used in combination with the wooden spatulas helps to level the mastic and prevents it from sticking to the spatulas / hands.

## Installation with mastic finish

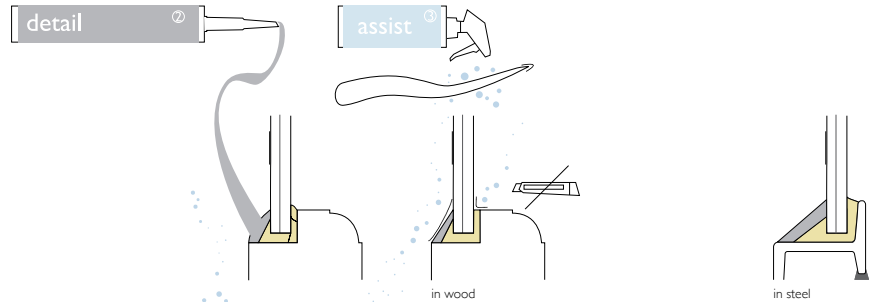

## Installation with glazing beads

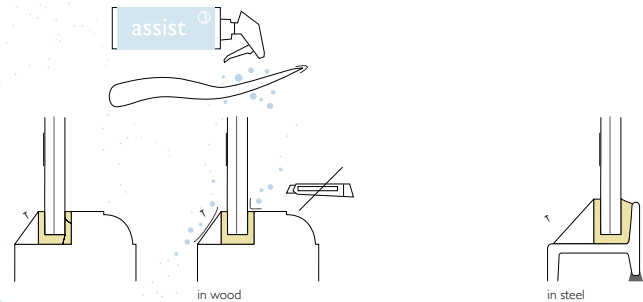

Van Ruysdael Detail could be replaced by glazing beads.